

Document Health & Safety	Published 11\1\2023	Valid for Escanaba Mill
-----------------------------	------------------------	----------------------------

Winter Parking Policy

Winter Parking Rules 2023-2024

Beginning November 13th we will have all “night shift” parking in Lot B on the mill side of the river to facilitate snow removal in Lot A during the night. This policy will be in effect during the winter months. Night shift is defined as 6pm-6am.

Lot B will be accessed from the driving bridge. There will be no vehicle parking in Lot A on night shift while this policy is in effect unless Lot B is closed for snow removal. Any team member working beyond 6pm, will be required to move their vehicle to Lot B by 6pm. Parking during day shift (6am-6pm) will be allowed in both Lot A and Lot B unless Lot B is closed for snow removal. Accessible handicap parking will be available in Lot B at all times. All vehicles must be registered with Loss Prevention before parking in Billerud employee parking lots.

Overnight parking is not permitted for company vehicles in front of the Administrative Office Buildings other than a few designated vehicles. These areas need to be clear for snow removal activities in the evening as well.

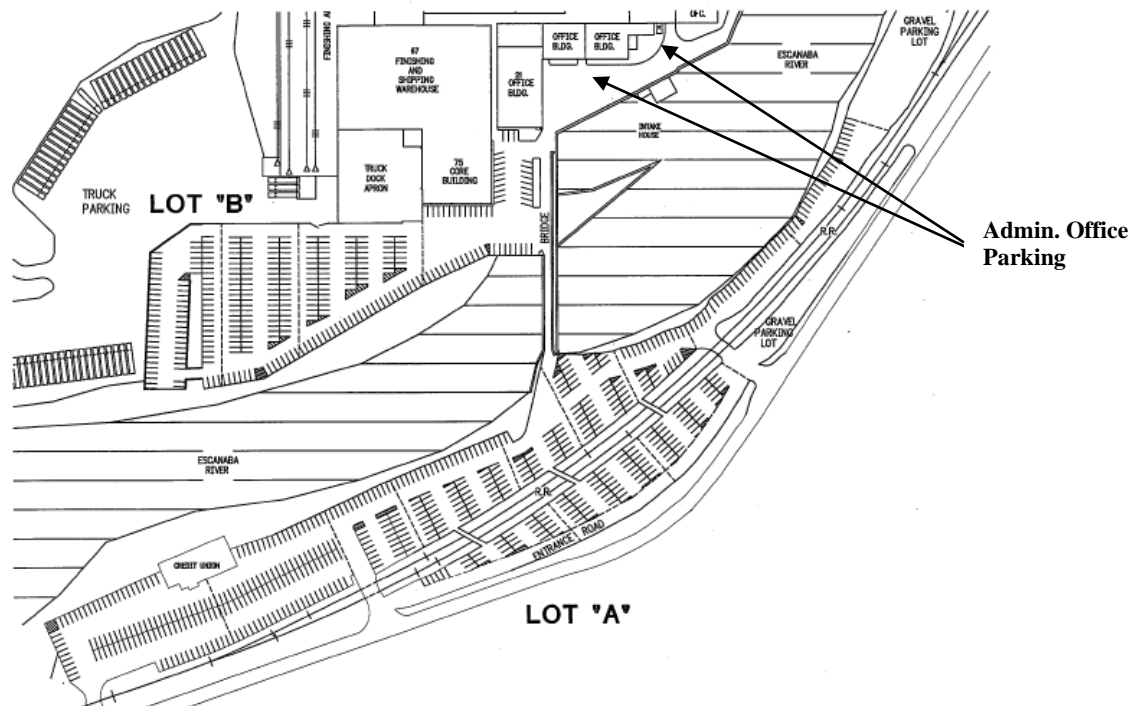

Yellow posts and orange barrels serve as parking guides in lot A. Parking spots are arranged parallel to the guard rails and the posts/barrels mark the middle of each row. There are orange triangles on the fences in Lot B that serve as parking guides as well.

Document Health & Safety	Published 11\1\2023	Valid for Escanaba Mill
-----------------------------	------------------------	----------------------------

Winter Parking Policy

This policy will be in effect during winter months and improperly/illegally parked or unregistered vehicles will be ticketed. Any questions can be directed to the Loss Prevention Department.